

- **APPLICATION**  
Suitable for chucking thin, small, medium and large workpieces.
- **DESIGN**  
Continuous transverse pole pitch, even holding force over the entire width. Pole divisions made of 0.5 mm brass/1.4 mm steel. Available with adaptation for zero-point workholding system.
- **TECHNICAL DATA**  
Rated holding force: 80 N/cm<sup>2</sup> (140 x 70)  
90 N/cm<sup>2</sup> (175x100)
- Magnetic field height: 6 mm
- Wear layer of the pole plate: 8 mm

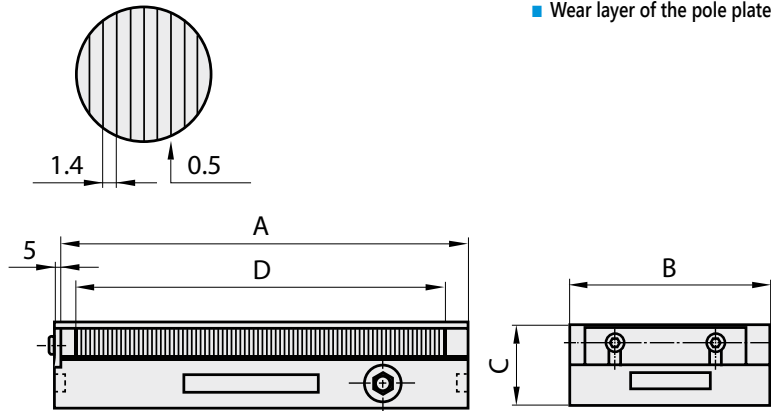

Code No.	A [mm]	B [mm]	C [mm]	D [mm]	Weight [lbs]
243.01-140x70	140	70	49	103	8
243.01-175x100	175	100	49	147	15
243.01-200x100	200	100	49	177	18
243.01-255x130	255	130	49	223	32
243.01-150x150	150	150	51	118	22
243.01-250x150	250	150	51	223	36
243.01-300x150	300	150	51	267	43
243.01-350x150	350	150	51	316	51
243.01-450x150	450	150	51	417	66
243.01-300x200	300	200	51	267	58
243.01-400x200	400	200	51	373	77
243.01-500x200	500	200	51	466	96
243.01-600x200	600	200	51	566	116
243.01-500x250	500	250	56	464	129
243.01-500x300	500	300	56	462	155
243.01-600x300	600	300	56	557	186